

INTEGRAL DIVERTER VALVE

FOR WALL HUNG RSF GAS-FIRED CONDENSING SYSTEM BOILER

GREENSTAR 30CDi System

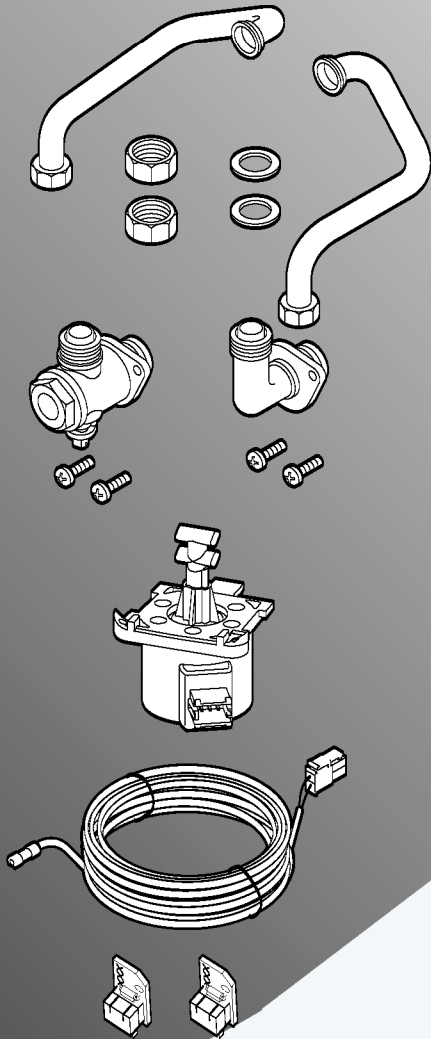

KIT CONTENTS:

- 1 COPPER FLOW PIPE
- 1 COPPER RETURN PIPE
- 2 15mm COMPRESSION NUTS
- 2 15mm OLIVES
- 2 BRASS SERVICE VALVES
- 4 SCREWS
- 1 DIVERTER VALVE MOTOR
- 1 CYLINDER TEMPERATURE SENSOR WITH CABLE AND CONNECTOR
- 2 CODE PLUGS (NATURAL GAS AND LPG)

GB/IE

INSTRUCTION MANUAL
INSTALLATION, COMMISSIONING
& SERVICING

IMPORTANT: THE FOLLOWING MUST BE COMPLETED BEFORE THE BOILER IS MOUNTED ON THE WALL

ASSEMBLY OF THE INTERNAL HOT WATER FLOW AND RETURN PIPES TO THE BOILER
Using the boiler packaging as protection turn the boiler on its left hand side to facilitate assembly of the hot water return pipe.

- ▶ 1. Move the control panel into the service position by removing the screw (A) from the retaining bracket.
- ▶ 2. Loosen the two retaining screws (B) to free the back clamping plate on the hydraulic block (C) shown in 3.
- ▶ 3. Remove the brass bung assemblies (D and E) from the hydraulic block by removing the clips and sliding them free from the flange on the clamping plate (C).
- ▶ 4. Take the copper pipe (F) from the Integral Diverter Valve Kit and feed the flat end of the pipe through the rear of the boiler as shown. Before fitting the pipe, check that the seal is in position on the plastic moulding. Slide the flat end of the pipe (G) under the flange (H) on the hydraulic block clamping plate (C) making sure that it is located correctly.
- ▶ 5. Take the copper pipe (I) from the Integral Diverter Valve Kit and feed the flat end of the pipe through the rear of the boiler as shown. Before fitting the pipe, check that the seal is in position on the plastic moulding. Slide the flat end of the pipe (G) under the flange (H) on the hydraulic block clamping plate (C) making sure that it is located correctly.
- ▶ Re-tighten the clamping plate by re-tightening the two screws (B) as shown in fig. 2.
- ▶ 6. On completion the pipe assembly should look as shown.
- ▶ 7. Assemble the service valves (J) and (K) included in the Optional Diverter Valve Kit and secure to the wall mounting frame as shown with two screws (L) supplied each.

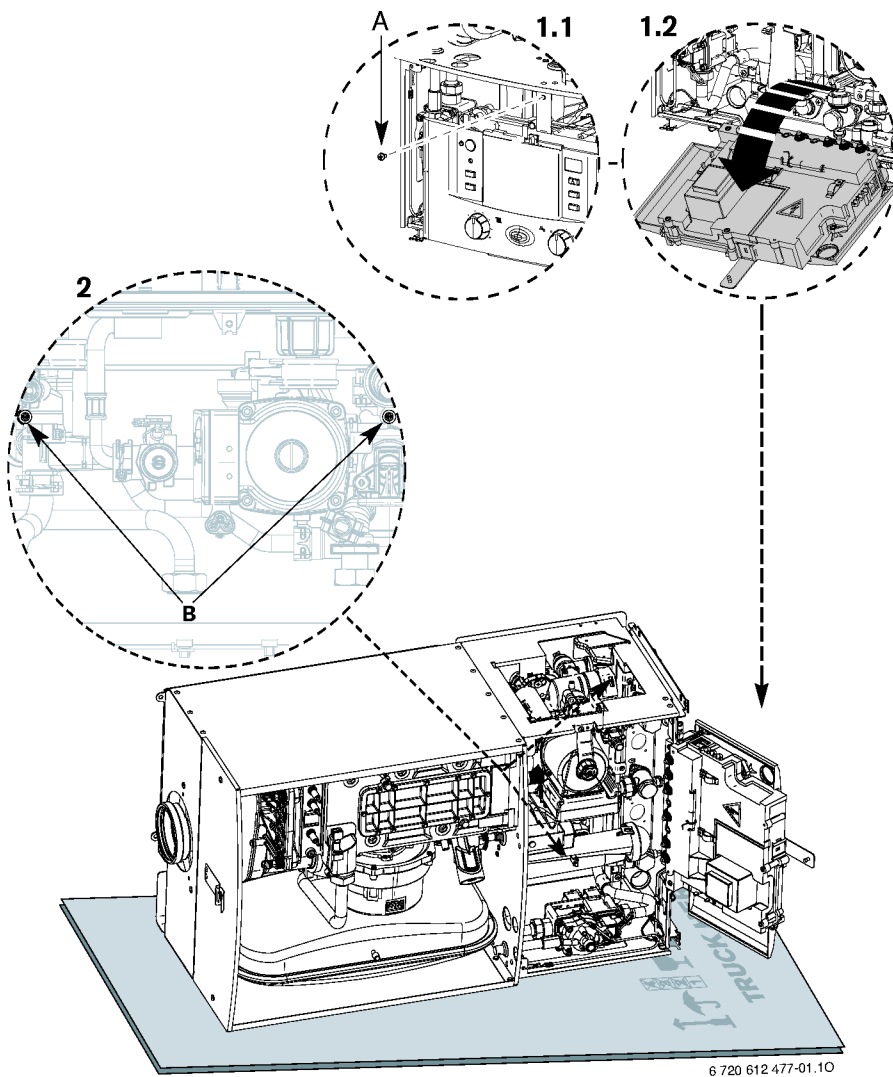

6 720 612 477-01.10

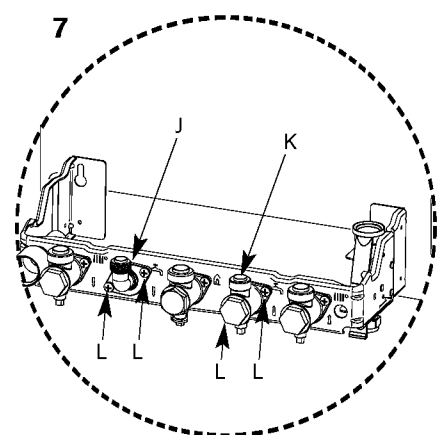
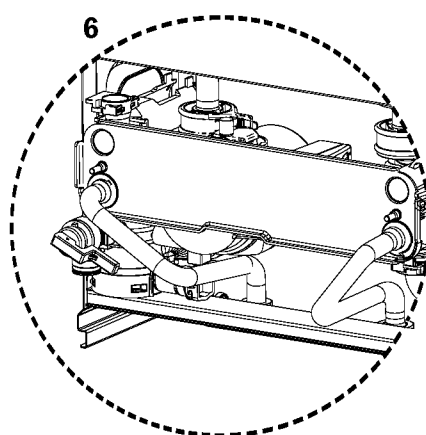
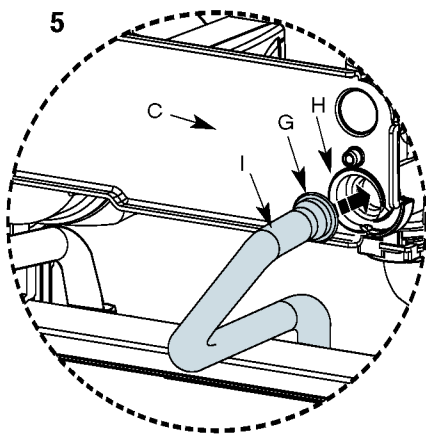
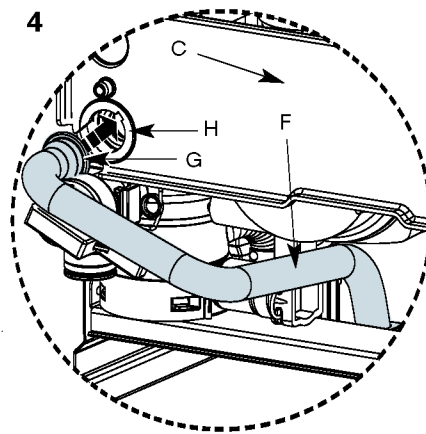
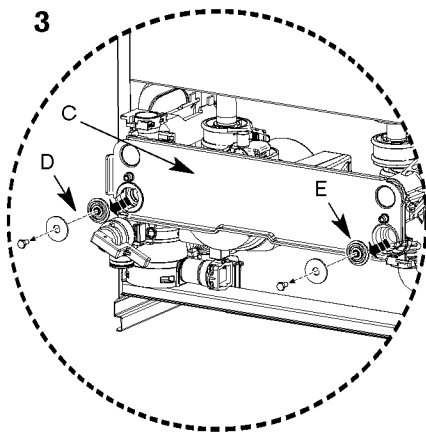

MOTOR

CAUTION: ISOLATE THE MAINS GAS SUPPLY BEFORE STARTING ANY WORK AND OBSERVE ALL RELEVANT SAFETY PRECAUTIONS.

- ▶ 1. Remove the diverter blanking plate (A) by pulling it forwards to free it from its location.
- ▶ 2. Replace with the diverter valve motor (B) by pushing it in until it clicks securely into place.
- ▶ 3. Connect the electrical harness (C) situated on the control panel to the diverter valve motor (B).
- ▶ 4. Remove the code plug (see page 5) from the control panel and cut the tie to the boiler chassis so that it can be completely discarded and replace with the correct one according to following table:

Gas type	Code plug No.
Natural Gas	1002
LPG	1003

- ▶ Make sure that the new code plug is secured to the boiler chassis.

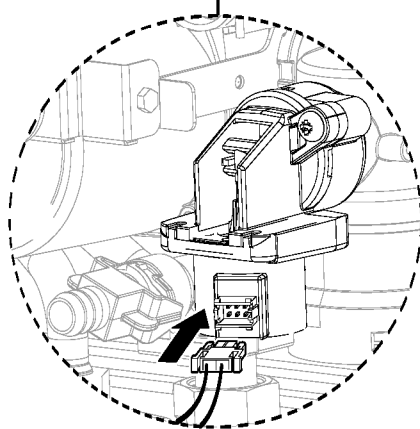
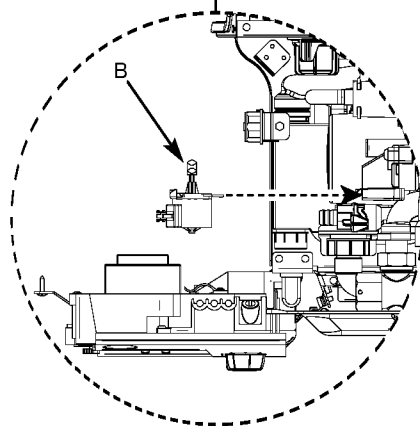
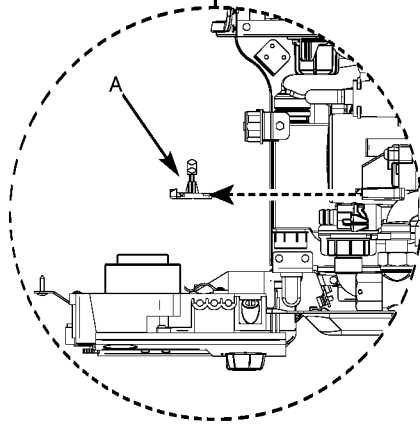
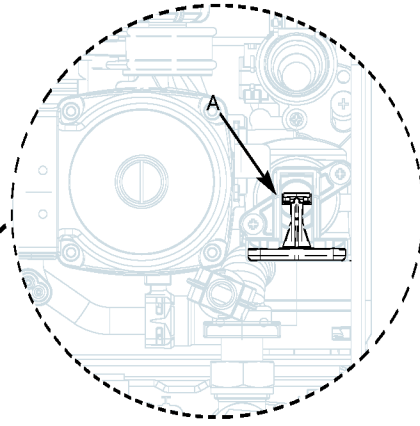
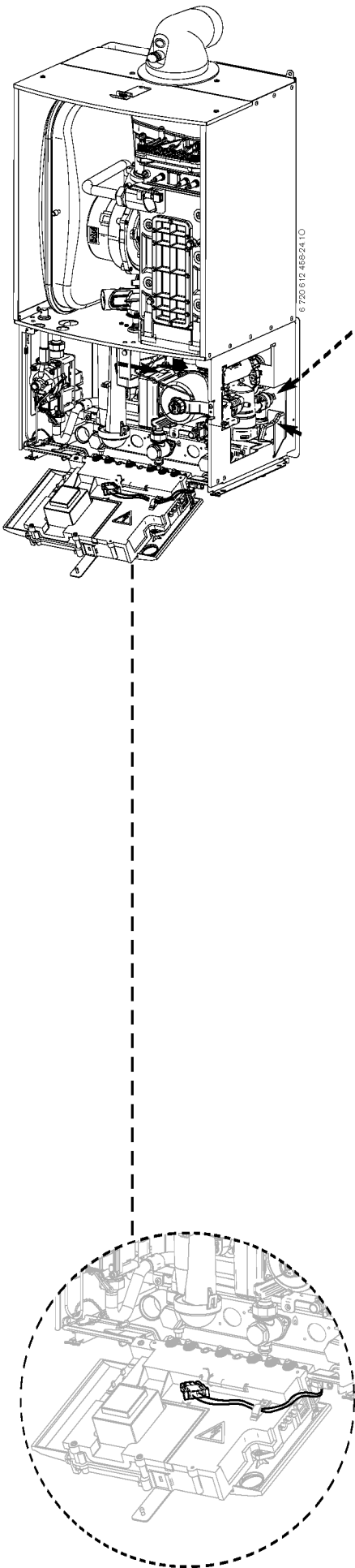

FITTING THE CYLINDER

TEMPERATURE SENSOR

The cylinder temperature sensor is used to give the boiler the actual temperature of the water in the cylinder. Therefore it has to be mounted under the thermal isolation of the cylinder.

- ▶ Mark a hole of approx. 5 x 10 cm at the desired sensor position (see instructions of cylinder).
- ▶ Cut and pull out the isolation.
- ▶ Coat sensor with heat conductive paste and place in the hole.
- ▶ Replace the isolation and fix with a cloth tape.

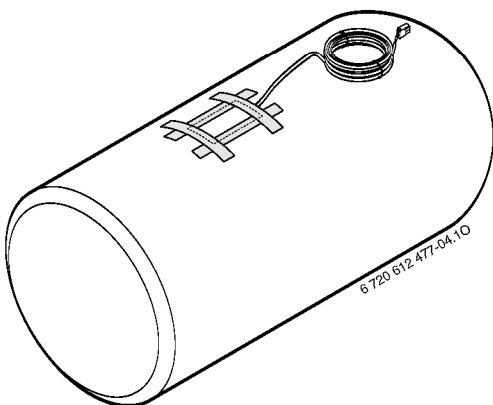
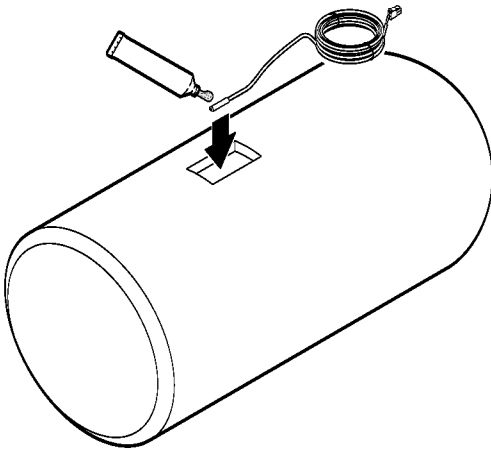
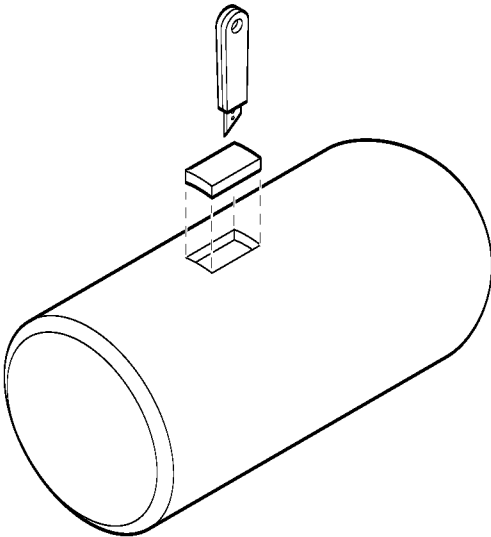

ELECTRICAL CONNECTION OF THE SENSOR

CAUTION: ISOLATE THE MAINS ELECTRICITY SUPPLY BEFORE STARTING ANY WORK AND OBSERVE ALL RELEVANT SAFETY PRECAUTIONS

Danger of short circuit: When connecting the cables ensure that no cable pieces fall into the Heatronic.

The cylinder temperature sensor is used to give the boiler the actual temperature of the water in the cylinder.

Note: In case the cylinder to be used with a volt-free cylinder stat the cylinder temperature sensor must not be mounted.

Access to electrical connections:

- ▶ Remove boiler casing to access control panel.
1. ▶ Lower the control panel into the service position by removing the screw (A) from the retaining bracket.
2. ▶ Unscrew the three screws (B) on the back of the control panel and pull off the connections cover.
3. ▶ Snap out the plastic tongue and insert the cable.
 - ▶ Insert the plug on the PCB ST15.*Note: If it is necessary to extend the cable to the tank sensor then a cable with a conductor size of not less than 1.5mm² must be used. Connections must be protected against short circuiting and water.*
4. Refit control panel cover:
 - ▶ Refit panel and secure with screws (B).
 - ▶ Bring the control panel to its upper position and fix it with screw (A).

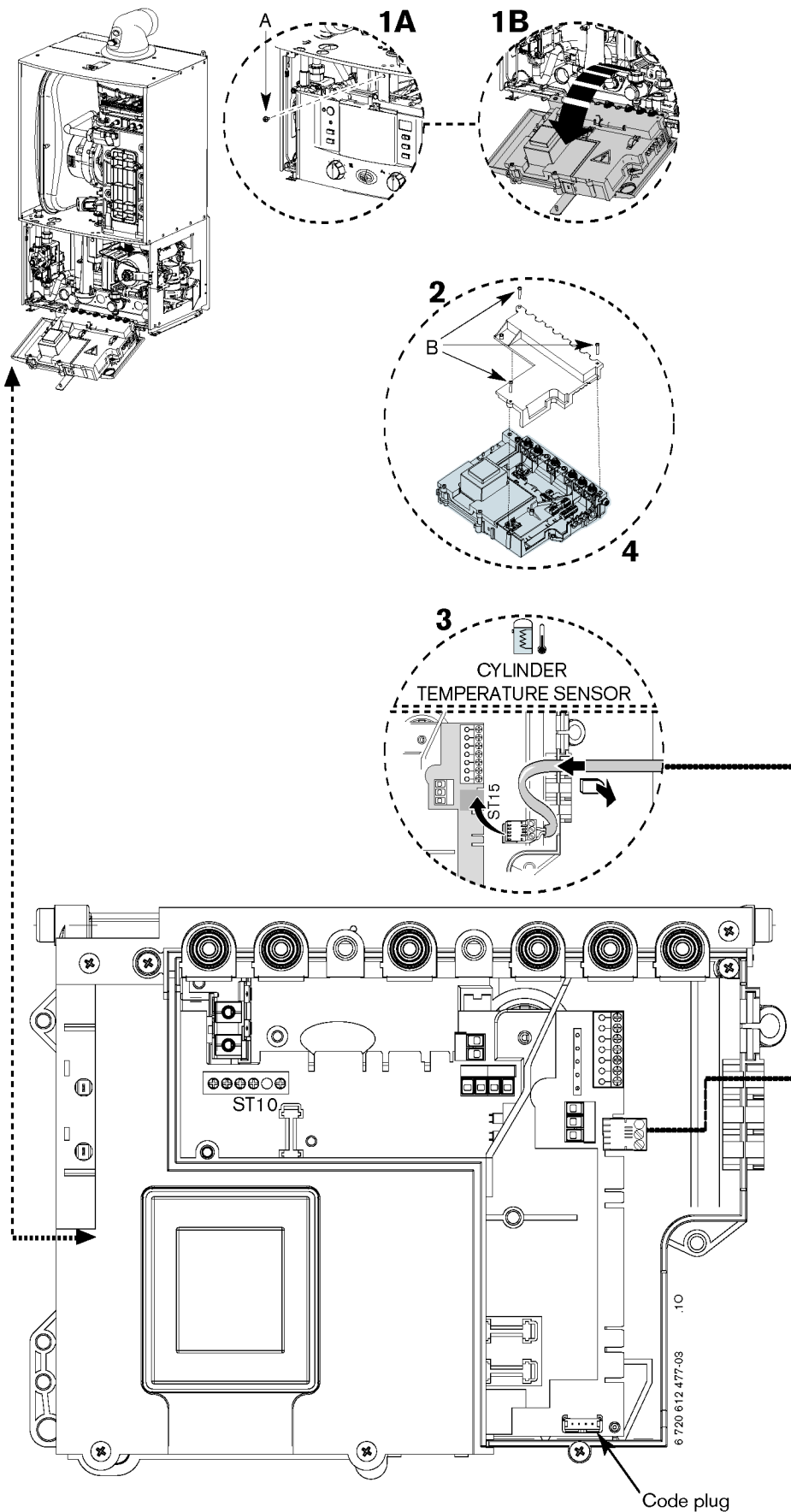

INSTRUCTION MANUAL INSTALLATION, COMMISSIONING & SERVICING

EXCELLENCE COMES AS STANDARD

Worcester, Bosch Group

Cotswold Way, Warndon, Worcester WR4 9SW.

Tel. 01905 754624 Fax. 01905 754619

Worcester, Bosch Group is a trading name of

BBT Thermotechnology UK Ltd.

www.worcester-bosch.co.uk

6 720 612 476b (2006/01) OSW

